

NOTE: BREAK ALL CORNERS WITH 0.015" (.38 MM) RADIUS UNLESS OTHERWISE NOTED. STANDARD TOLERANCES TO APPLY UNLESS OTHERWISE SPECIFIED.

CUSTOMER <b>CAN ART STD.</b>	DIE No. <b>EH05239</b>	REV. No. <b>5</b>
---------------------------------	---------------------------	----------------------

DESCRIPTION <b>1" SCHED. 40 PIPE</b>	CUSTOMER PART No.	QUOTE No. <b>13-1220-1-R-1</b>	PROPOSAL No.
---	-------------------	-----------------------------------	--------------

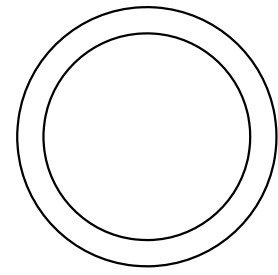
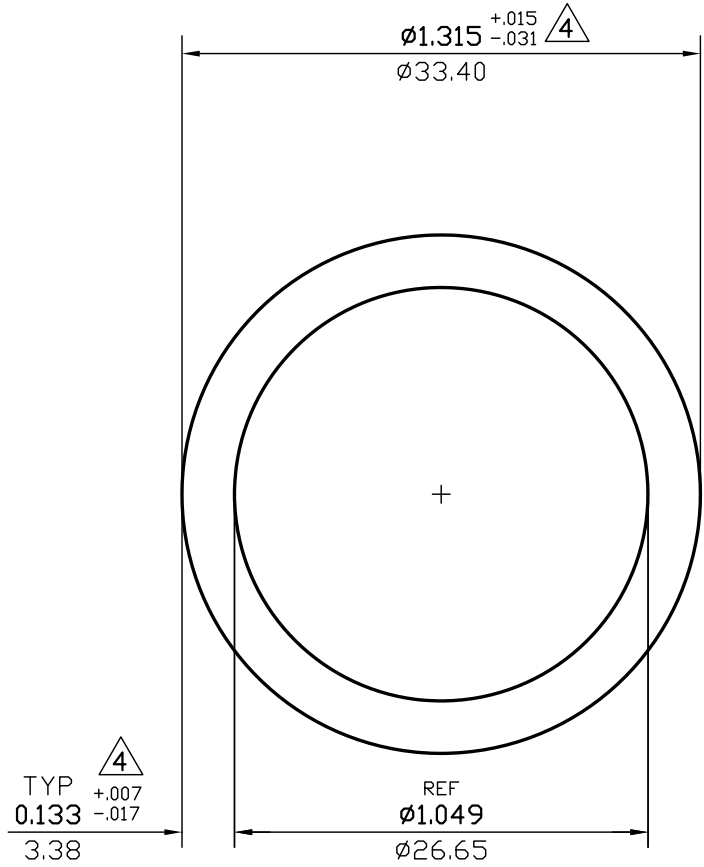

ACTUAL SIZE

WALL THICKNESS (AS SHOWN) EXCEPT AS SHOWN

DATE	REV	DESCRIPTION	BY
03/10/23	5	REMOVED EXPOSED SURFACES AND ALLOY	JASON
11-08-13	4	REVISED TOLERANCES.	PAUL
EST.AREA	0.494	IN. <sup>2</sup>	EST.AREA 318.632
			MM. <sup>2</sup>
EST.WT.	0.583	LBS./FT.	EST.WT. 0.867
			KG/M.
EST.PER.	7.427	IN.	EST.PER. 188.639
			MM.
OUT PER.	4.131	IN.	OUT PER. 104.9
			MM.
C.C.D.	1.315	IN.	C.C.D. 33.401
			MM.
FINISH	M/F		ALLOY
CKD BY	FACTOR 13	SCALE 2:1	DWN BY C.P. DATE 05/03/2004

# CAN ART

ALUMINUM EXTRUSION INC.

85 PARKSHORE DRIVE  
BRAMPTON, ONT L6T 5M1  
TEL. NO. (905) 791-1464  
FAX NO. (905) 791-9151  
WEB: www.canart.com

THIS DRAWING IS NOT NECESSARILY A COPY OF YOUR ORIGINAL. PLEASE APPROVE DIMENSIONS AND TOLERANCES INDICATED. CAN ART ASSUMES NO RESPONSIBILITY EITHER TECHNICAL OR LEGAL FOR HAVING THIS SHAPE MADE. THE CUSTOMER AGREES TO FULLY PROTECT CAN ART ALUMINUM FROM CLAIMS OF OTHERS RESULTING FROM THIS SHAPE.

SIGNED: \_\_\_\_\_ DATE: \_\_\_\_\_